

Please send the completed form to:

Callington Town Council
The Town Hall
New Road
Callington
Cornwall, PL17 7BD

or by email to: clerk@callington-tc.gov.uk

www.callington-tc.gov.uk



Call for Sites

Callington and Kelly Bray Neighbourhood Plan

Data Protection and Environmental Information Regulations

We need permission to hold your details on our database. Submission of a form electronically will be taken as consent to process your personal data. Please confirm your consent below by ticking the box:

- I give consent that my contact details and related responses can be held by Callington Town Council and I understand that they will only be used in relation to neighbourhood planning matters.

Completion notes

- Please complete one form for each site.
- You must give your name and address for your submission to be considered
- You must include a map or aerial photograph showing the precise boundaries of the site
- Please submit your response by Friday 7th September 2018.

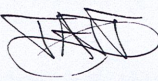
Please sign (or type your name if submitting electronically):		Date:	19.8.18.
---	---	-------	----------

This information is collected by Callington Town Council as data controller in accordance with the Data Protection Act 2018. The purposes for collecting this data are:

- inform other work associated with the Callington and Kelly Bray Neighbourhood Plan, and
- to contact you, if necessary, regarding the answers given on this Proforma.

The form may also be used in discussion with other parties e.g. parish councils, developers, residents and Cornwall Council, but the contact details on the first two pages will be detached and held separately. Data will be kept for as long as it is considered useful for the above purposes.

Any recorded information held by Callington Town Council can be requested under the Freedom of Information (FOI) Act 2000 or the Environment Information Regulations (EIR) 2004.

The Council shall act reasonably and use its discretion when making a decision to release or withhold this information.

If you have any concerns regarding the processing of your data, please call Town Clerk Helen Dowdall on 01579 384039 or email clerk@callington-tc.gov.uk Keeping in touch.

- Yes please, I would like to receive communications by email.
- Yes please, I would like to receive communications by telephone.
- Yes please, I would like to receive communications by mobile phone including text message.
- Yes please, I would like to receive communications by social media including Facebook.
- Yes please, I would like to receive communications by post.

Callington and Kelly Bray Neighbourhood Plan will need to allocate sites for future development.

As part of the work to prepare the plan the steering group have decided to issue a call for sites.

It should be noted that the identification of potential housing, employment and other sites through the call for sites does not indicate that planning permission will be granted or that a site will be allocated for future development in the Neighbourhood Plan.



Your Details

Name:	TROUP BROTHERS		
Address:	c/o 46 KYL COBER PARC, STOKE CLIMSLAND PL17 8PH		
Telephone Number:	07966 596 224		
Email address:	james@jamestroup.com		
Are you the owner of the site?	<input checked="" type="checkbox"/> Yes - Sole Owner <input type="checkbox"/> Yes - Part Owner <input type="checkbox"/> No - Acting as agent AS TROUP BROTHERS		
Please name any other parties with an interest in the site	NONE (currently has a tenant farmer)		
Please confirm whether all parties with an interest in the site have agreed for it to be submitted?	<input checked="" type="checkbox"/> Yes <input type="checkbox"/> No		
Do you give your consent for members of the Neighbourhood Plan Steering Group or their appointed consultants to access the site for the purpose of assessing it for the Neighbourhood Plan?	<input type="checkbox"/> Yes	<input checked="" type="checkbox"/> Yes if accompanied by the landowner / agent by arrangement.	<input type="checkbox"/> No

Site Details

Site address or description of the location	Wonnacraft Farm		
	20 - 21 acres.		
What is the current use of the site?	Agriculture		
What type of development do you think the site is suitable for?	<input checked="" type="checkbox"/> Housing <input type="checkbox"/> Employment <input type="checkbox"/> Mix of employment & housing <input type="checkbox"/> Community uses <input type="checkbox"/> Not sure <input type="checkbox"/> Other (please explain below)		
We are open to discussion.			
Please provide any further details on the potential use of the site here:			
If the site is suitable for housing approximately how many homes do you think could be provided?	240+ depending on density.		

To the best of your knowledge are there any constraints that prevent the site from being developed? Please provide details.	Access difficulties:	NO
	Amenity Issues e.g. Dust, Noise, Smell:	NO
	Contamination:	NO
	Environmental Designation:	NO
	Flood Risk:	NO
	Infrastructure/Utility Requirements:	NO
	Legal Issues e.g. Covenants:	NO
	Local Character:	NO
	Ownership Issues:	NO
	Planning policies:	NO
	Topography:	NO
	Tree Cover:	NO
	Viability:	NO
	Other consideration (Please explain):	NO
Do you consider that the constraints on the site can be overcome? If so please explain how?	N/A	
Is the site currently for sale?	NO	
Is there current interest from a developer?	There has been.	
Is the site immediately available for development?	Yes.	
If the site is not immediately available when do you think it could be available for development?	<input type="checkbox"/> Within the next 5 years <input type="checkbox"/> Within 6 to 10 years <input type="checkbox"/> Within 11 to 15 years <input type="checkbox"/> After 15 years	

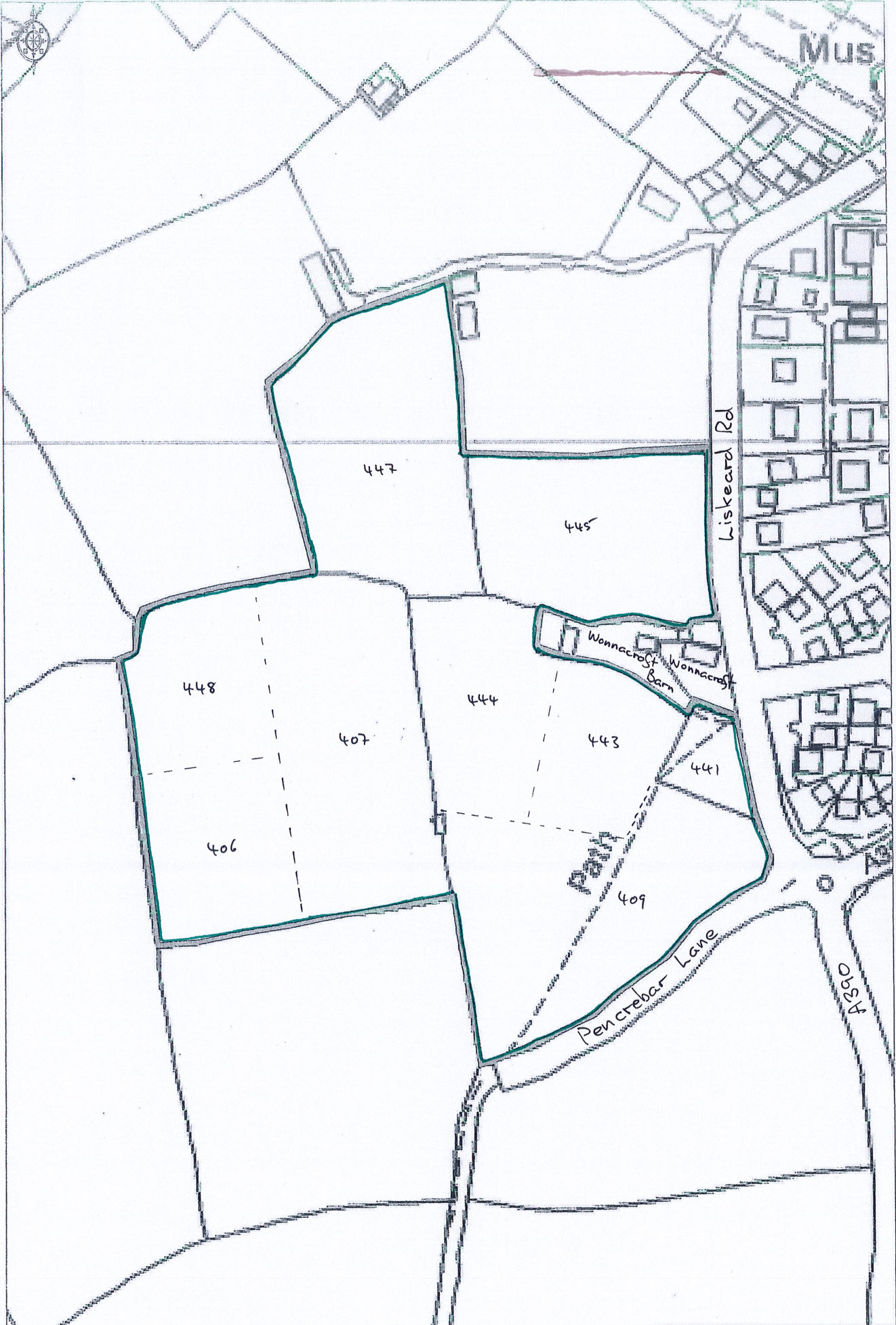

---- Removed boundaries.